

! CAUTION

1. Disassemble the fittings in reverse order.
2. Do not attempt to assemble these fittings to the hose without using a mandrel.

Assembly

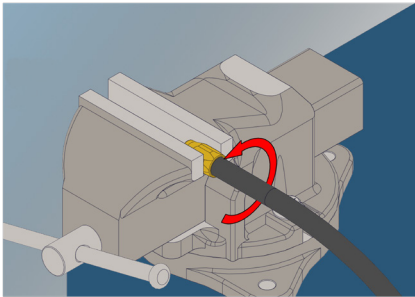

1. Screw hose into socket (left hand thread) until it bottoms. Back out hose $\frac{1}{4}$ turn.

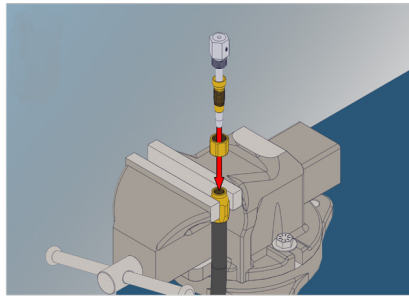

2. Slide the insert onto the mandrel. Lubricate the hose ID and the insert of the sub-assembly with lubricating oil or light grease.

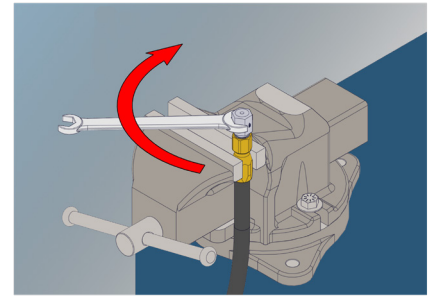

3. The insert is then threaded into the socket and hose. Leave $\frac{2}{16}$ inch clearance so nut is free to swivel.

Maintenance

1. Clean the hose assembly by blowing out with air.
2. Inspect the hose by looking through the assembly for any possible obstructions or foreign matter. Clean hose ID as necessary.
3. Swivel nuts should turn freely.
4. Check the layline of the hose to be sure the assembly is not twisted.
5. Cap the ends of the assembly to keep clean.

Parts List

Part Description	Part Number
assembly tool for HS1488 end fitting size (-04) assembly	B22811
assembly tool for HS1488 end fitting size (-05) assembly	B22812
assembly tool for HS1488 end fitting size (-06) assembly	B22813
assembly tool for HS1488 end fitting size (-08) assembly	B22814
assembly tool for HS1488 end fitting size (-10) assembly	B22815
assembly tool for HS1488 end fitting size (-12) assembly	B22816
assembly tool for HS1488 end fitting size (-16) assembly	B22817
assembly tool for HS1488 end fitting size (-20) assembly	B22818